

## How to Attach Bock Side Support Rail - Ordering Code: 5131

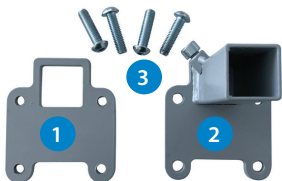

.bock<sup>///</sup>

### REQUIRED COMPONENTS



*Included with the side rail:*

1. Flat bracket
2. Tube bracket
3. Bolts (x4)

*Also required:*

2x Allen keys: 5mm and 6mm  
(not included with side rail)

### WARNINGS

**Please read before using this product:**



**CAUTION!** Beware of pinch points when assembling the side rail.



**CAUTION!** The distance between the side rail and the inside face of the headboard/footboard **MUST** be less than 60mm or greater than 318mm.

### HOW TO INSTALL THE SIDE RAIL

*Assembling the brackets:*

Place the flat bracket (1) inside the side frame of the bed.

Place the square pipe of the tube bracket (2) below the bed frame and through the hole in the flat bracket (1). Move inwards until both sides of the bracket are flush to the bed frame.

Use all four bolts (3) to attach from the outside and tighten using the 5mm Allen key.

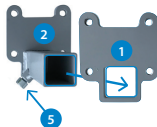

*Side view of attached brackets:*

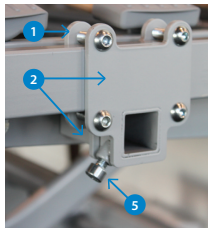

*Top view of attached brackets:*

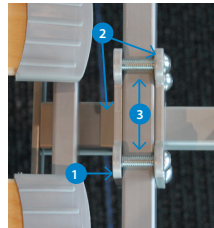

*Fitting the rail:*

Insert the square pole of the side rail (4) into the tube of the bracket (2) and use the 6mm Allen key to tighten the locking lug (5).

